



# Table Lamp Cord Replacement

This step-by-step guide teaches the users two...

Written By: Aysha Vear



# INTRODUCTION

This step-by-step guide teaches the users two procedures: removing and replacing an old lamp cord and attaching a new cord to the socket.



## TOOLS:

- [Utility Scissors](#) (1)
- [Flathead Screwdriver](#) (1)
- [Tweezers](#) (1)



## PARTS:

- [Lamp Kit](#) (1)



## Step 1 — Cord



- Required materials: AAMP rewire kit, light bulb (not pictured), lamp shade (optional).
- The AAMP lamp rewire kit should include a new cord, a socket shell, a socket interior and bottle adaptors. (Refer the second image to view the contents of the kit).

## Step 2



**⚠ Caution!** Before removing the lightbulb, ensure that the lamp is unplugged.

- Cut the old lamp wire using scissors.
- Remove the cord from the lamp.
- Dispose the cord.

### Step 3



- Thread the new wire through the hole on the bottom of the lamp. Pull it out through the top of the lamp base. (Refer the first image to get a better understanding.)
- Place the old check ring on top of the lamp with the wire threaded through it. (Refer the second image to see the check ring.)

## Step 4

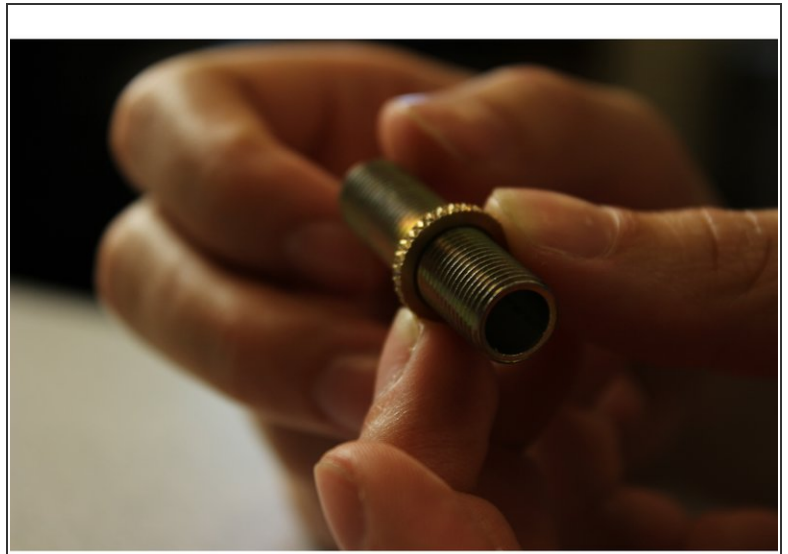
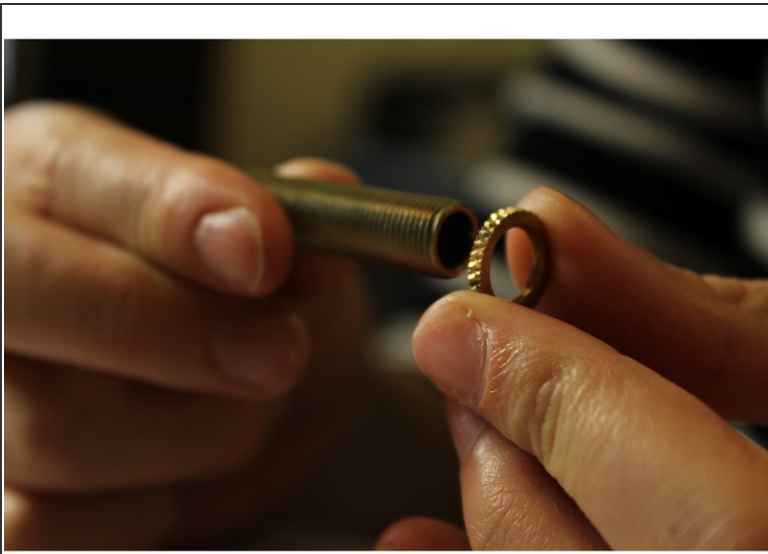

- Place the lock nut at the end of the lamp nipple and turn it clockwise.
- Thread the lock nut a quarter of the way through the lamp nipple.

## Step 5

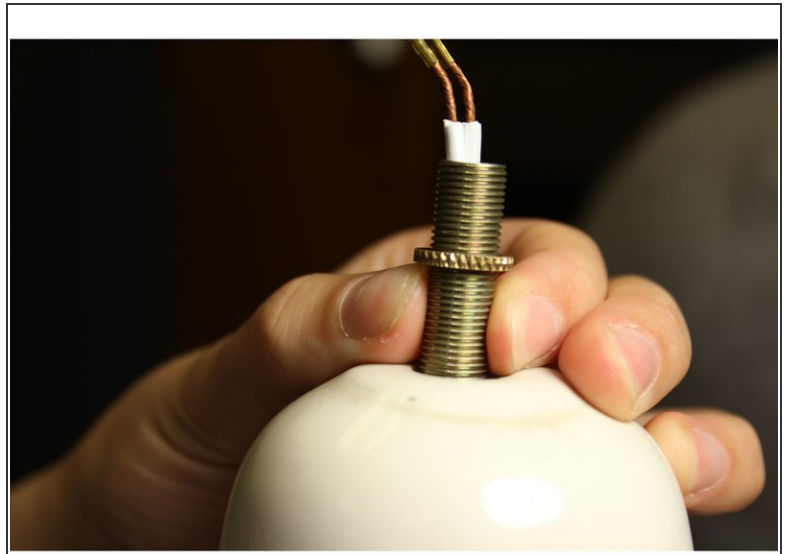

- Ensure that the lamp cord sticks through the top of the lamp base.
- Insert the lamp nipple and the lock nut into the bottle, in such a way that one-fourth inch of the lamp nipple faces up.

## Step 6



- Insert the socket in the lamp nipple.
- Tighten the socket by turning it clockwise until it reaches the lock nut.



## Step 7

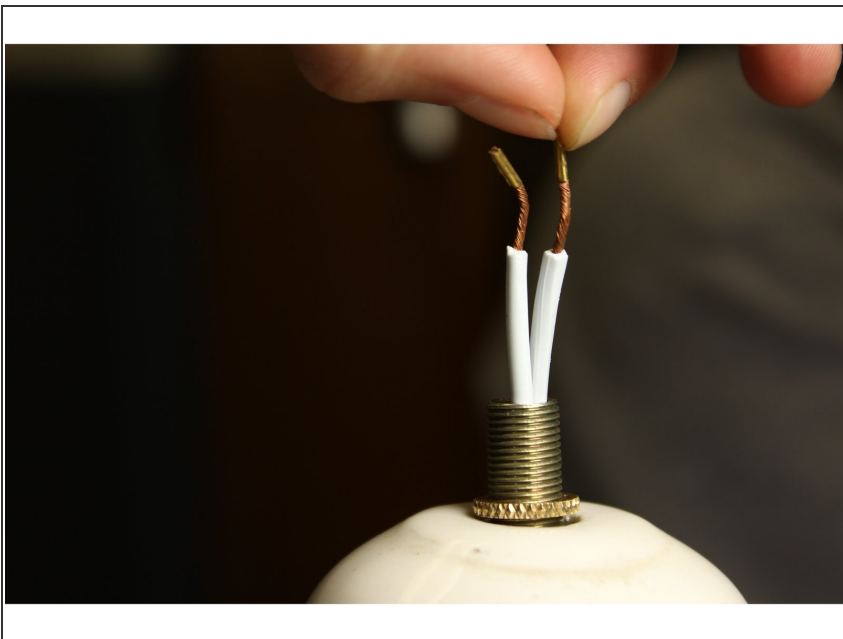

- Pull either ends of the wire so that you have about 2-3 inches of the wire separated.

## Step 8

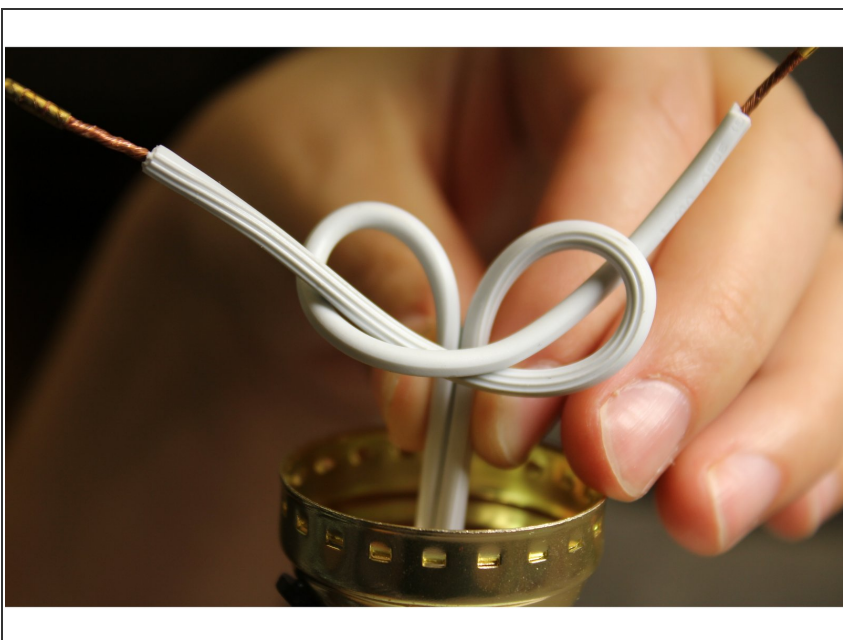

- Tie an underwriter's knot in the two separated pieces of wire.
- ⓘ How to tie the knot: Form a loop using the first wire. Take the second wire and form a loop around the first. Pass the tail of the second wire through the loop of the first.

## Step 9



- Check both the conductors at the end of the wire. Find the ribbed conductor and wrap it around the silver-colored screw. Connect the other conductor to the brass-colored screw.
- Tighten both of the screws in a clockwise direction. Make sure the conductors are securely under the screw head.

## Step 10

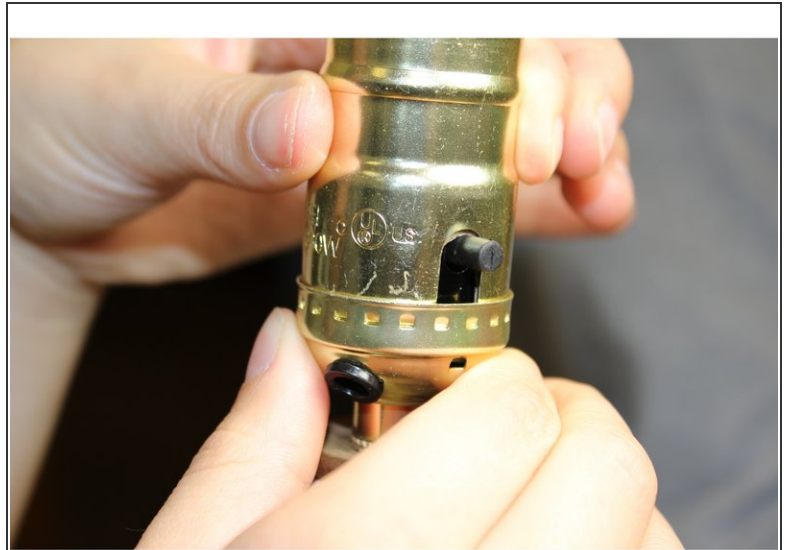
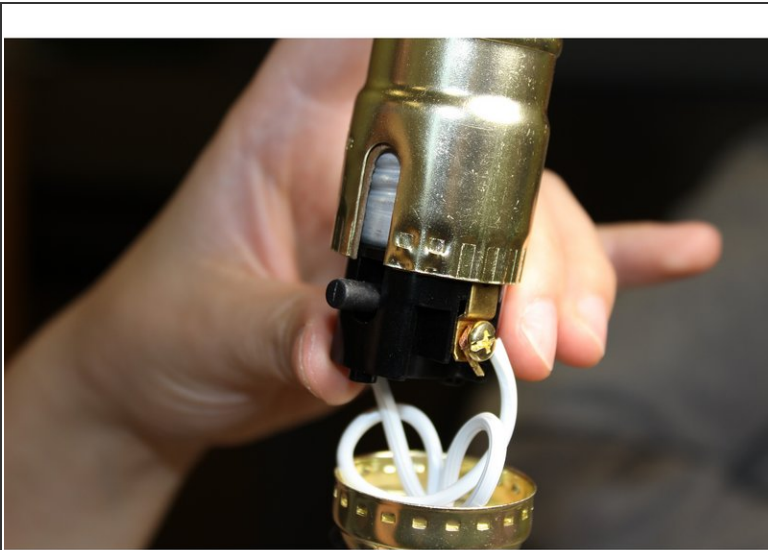

- Place the socket shell (with paper liner) over the socket interior. Snap it into correct position. Listen for clicks to make sure that the shell is locked properly.
- The socket should snap together to form one piece.



## Step 11



**⚠ Caution:** Be sure that the rewired lamp is not plugged at this step.

- Insert the new light bulb into the socket. Plug the cord and turn it on.

To reassemble your device, follow these instructions in reverse order.