



How to find Sony Xperia Z2 Model, Serial, Identification Number, IMEI

Sony Xperia Z2 - How to Find Model, Serial, Identification Number, IMEI

Written By: ZFix



INTRODUCTION

Because, for this model the battery / back cover is glued to the phone frame, you can't find there the sticker with the serial number, model name and other information for the phone.

[video: <https://www.youtube.com/watch?v=CGYBeSJSdkg>]



TOOLS:

- [SIM Card Eject Tool](#) (1)
-

Step 1 — How to find Sony Xperia Z2 Model, Serial, Identification Number, IMEI

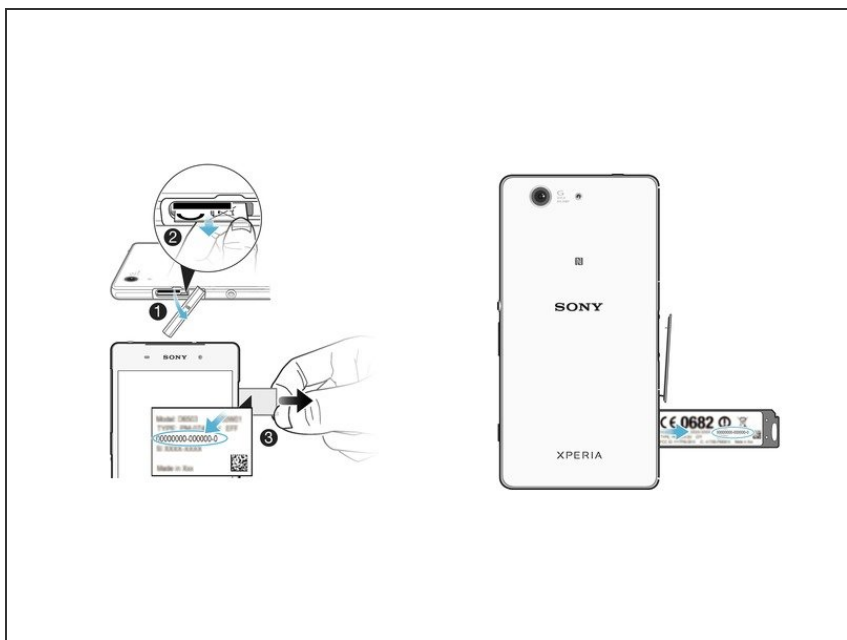

- Open the SD card cover.
- Place a fingernail or sharp object under the edge of the label tray and carefully then drag the tray outwards to view your IMEI number, model, etc.

To reassemble your device, follow these instructions in reverse order.