

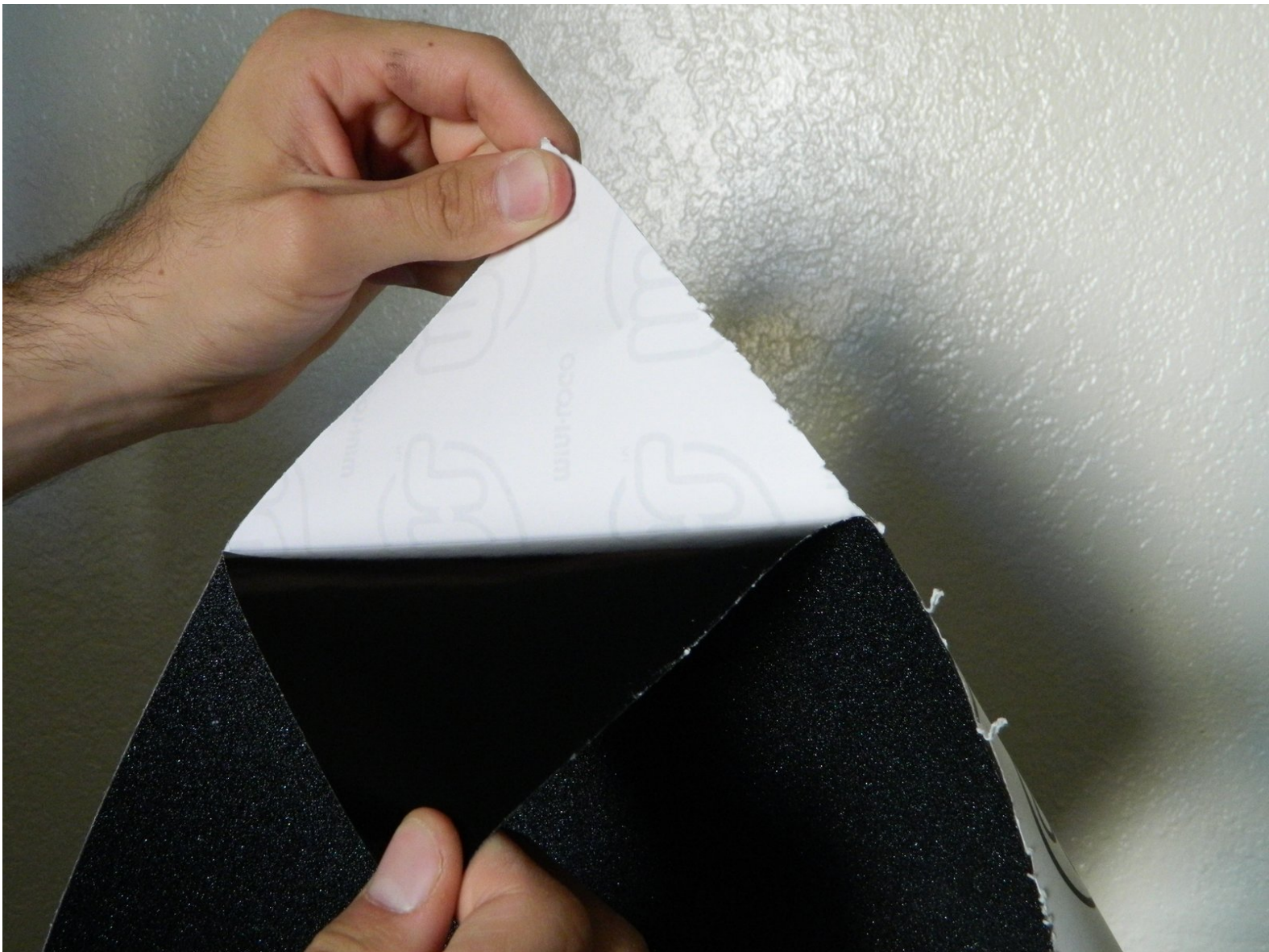

Grip Tape Application

By the end of this guide you will be able to apply a standard sheet of grip tape to any skateboard deck.

Written By: Jared Stine



INTRODUCTION

If you have just bought your skateboard deck, strip the plastic from it and remove any stickers that are on the top of the deck where the grip tape will be applied. Be sure to have all of your tools and materials close by to make the installation process faster and more efficient.

TOOLS:

- [Utility Knife](#) (1)
 - [Phillips #1 Screwdriver](#) (1)
-

Step 1 — Grip Tape Application

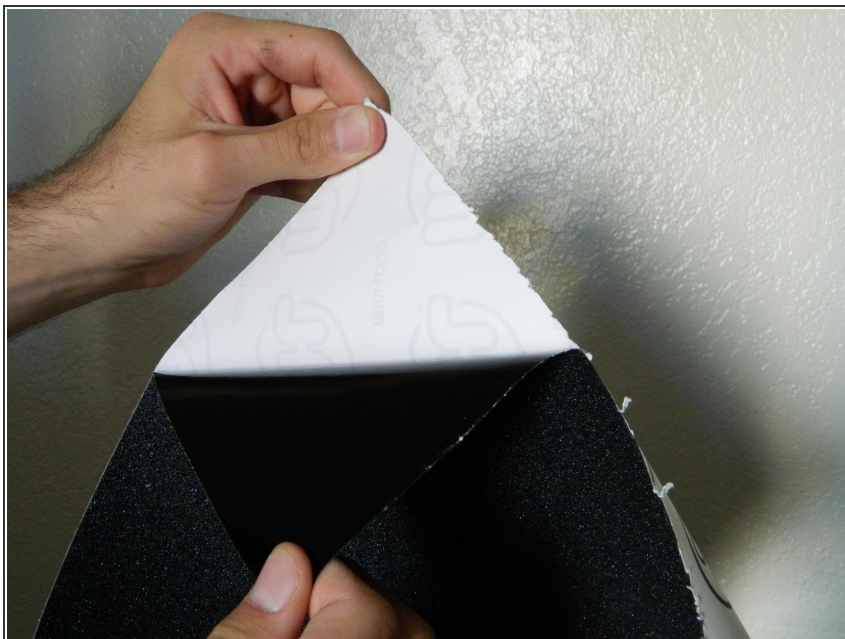

- Peel off the paper backing from the sheet of grip tape.
- ⓘ Make sure you do not fold or wrinkle the grip tape.

Step 2



- Center the sheet of grip tape evenly over the top of the skateboard deck.

Step 3



- Starting from the very middle and moving outward, firmly press down on the grip tape while smoothing out any air bubbles that start to form.

Step 4

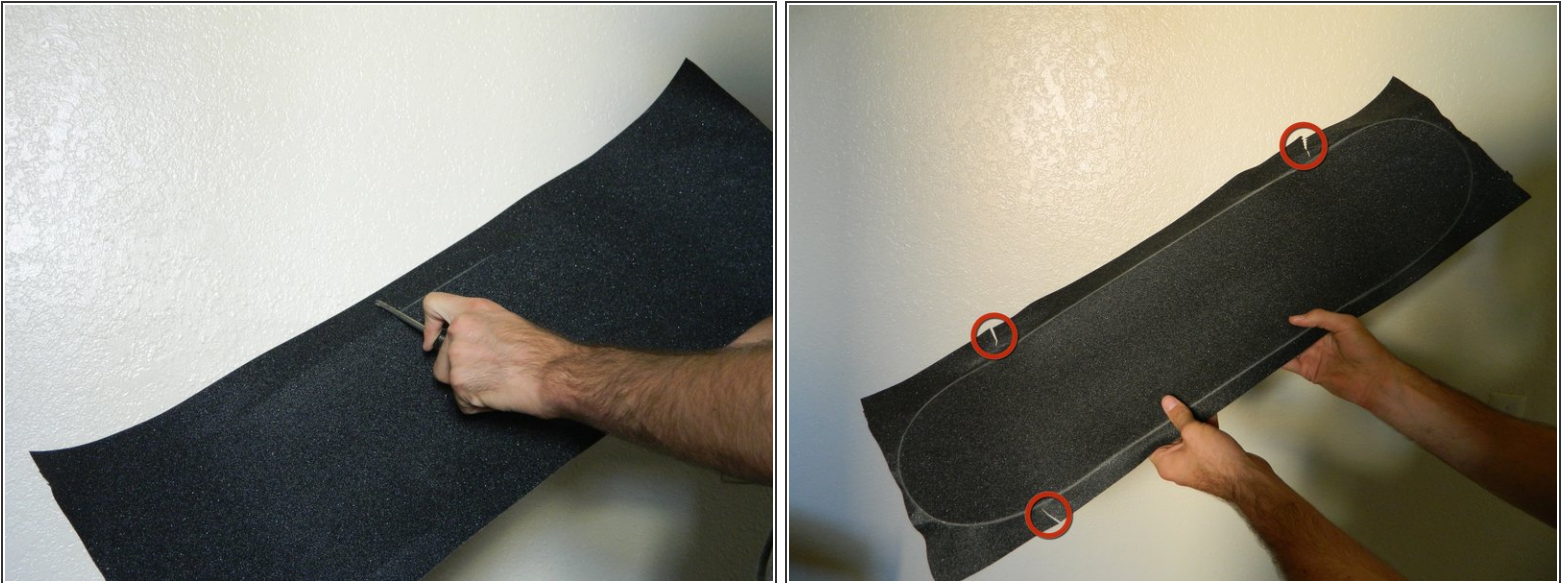

- Use a screwdriver to scrape along the edges of the skateboard. This will remove some of the grip around the edges making the trimming process easier on you and your equipment.
- You can use the utility knife to cut a perpendicular line in the excess grip tape if it is resisting the screwdriver too much.

Step 5



- Use a utility knife to begin cutting around the edge of your skateboard to remove excess grip tape.
- ⓘ Angle your knife towards the inside of the skateboard to make it easier to cut a straight line.
- ⚠ Be careful when using the utility knife and always keep it pointed away from yourself and others.

Step 6



- Once you have removed all of the excess grip tape, you can use the scraps to sand the edges of your cut to smooth out any small inconsistencies.

 Use caution when sanding as the grip tape can become heated.

Step 7



- If air bubbles persist, gently use a utility knife to poke a small hole in the grip tape at the center of the bubble and press out the air.

 Be careful when using the utility knife and always keep it pointed away from yourself and others.

Step 8

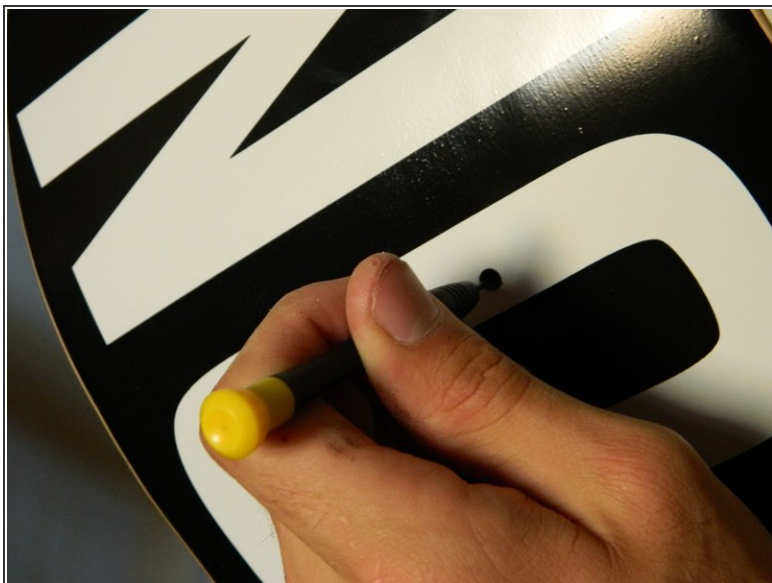

- After you have finished applying your grip tape, you can use a small screwdriver to poke holes where your truck hardware will be installed.

The next logical step in the assembly of a skateboard is to install skateboard trucks, please reference the [Truck Installation](#) guide.