



Toshiba Satellite 2430-S255 Battery Replacement

This repaired guide provides a step by step walk-through of how to replace the battery for a Toshiba Satellite 2430-S255

Written By: Jacob Zuliani



INTRODUCTION

This repaired guide provides a step by step walk-through of how to replace the battery for a Toshiba Satellite 2430-S255

To make sure the battery is not properly working and is in need of replacement, refer to this [troubleshooting guide](#)

Step 1 — Battery



- Locate the battery locking mechanism on the back side of the laptop. It is labeled with a lock and unlock symbol to indicate its function. The mechanism also has a serrated texture to increase grip.

Step 2

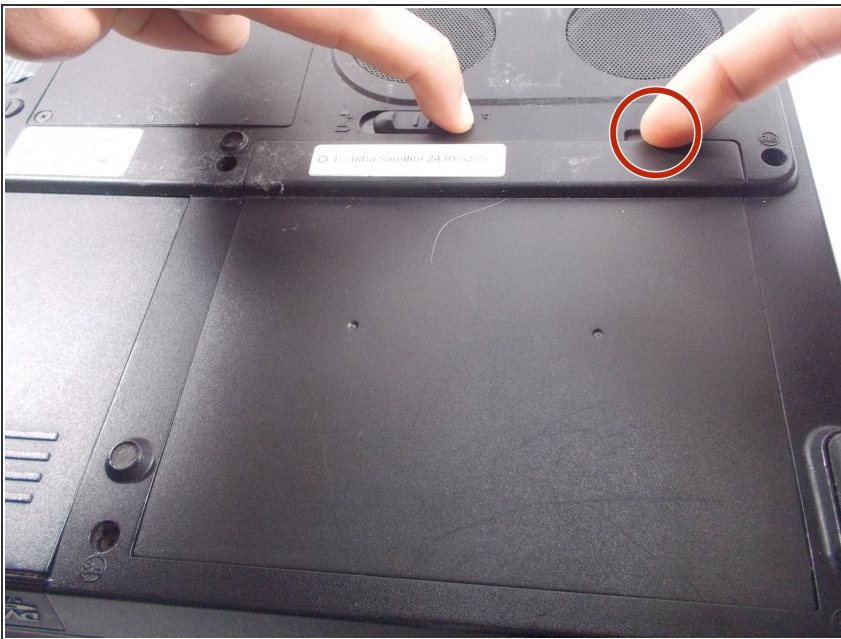

- Place your left hand on the locking mechanism and slide it all the way to the left. This will move it into the unlocked position. While holding the mechanism in the unlocked position place another finger in the cavity to the right of the locking mechanism.

Step 3



- Pulling up with your right hand while the locking mechanism in the unlocked position will release the battery from its socket.

To reassemble your device, follow these instructions in reverse order.